

Flange Nuts

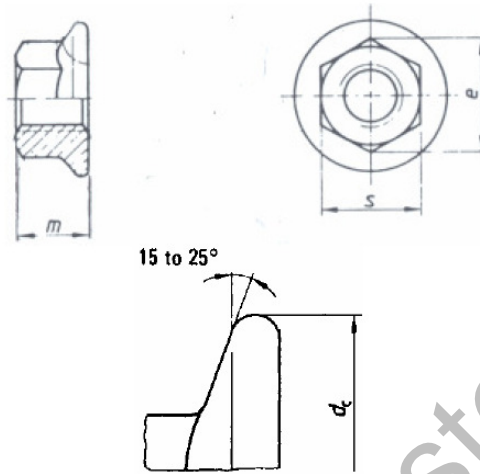

Diameter	E		M		s	dc	
	Min.	Max.	Min.	Max.		Min.	Max.
M3-0.5	6.01	3.70	3.50	5.50	5.33	8.0	
M4-0.7	7.66	4.50	4.30	7.00	6.83	10.0	
M5-0.8	8.79	5.00	4.70	8.00	7.78	11.8	
M6-1.0	11.05	6.00	5.70	10.00	9.78	14.2	
M8-1.0	14.38	8.00	7.60	13.00	12.73	17.9	
M8-1.25	14.38	8.00	7.60	13.00	12.73	17.9	
M10-1.0	16.64	10.00	9.60	15.00	14.73	21.8	
M10-1.25	16.64	10.00	9.60	15.00	14.73	21.8	
M10-1.5	16.64	10.00	9.60	15.00	14.73	21.8	
M12-1.25	20.03	12.00	11.60	18.00	17.73	26.0	
M12-1.5	20.03	12.00	11.60	18.00	17.73	26.0	
M12-1.75	20.03	12.00	11.60	18.00	17.73	26.0	
M14-1.5	23.36	14.00	13.30	21.00	20.67	29.9	
M14-2.0	23.36	14.00	13.30	21.00	20.67	29.9	
M16-1.5	26.75	16.00	15.30	24.00	23.67	34.5	
M16-2.0	26.75	16.00	15.30	24.00	23.67	34.5	
M20-1.5	32.95	20.00	18.90	30.00	29.67	42.8	
M20-2.5	32.95	20.00	18.90	30.00	29.67	42.8	
M24-3.0	40.31	24.00	22.90	36.00	35.67	51.0	

Specification Requirements:

- Dimensions: M5-M20: DIN 6923.
M3, M4, and M24: See dimensions above
- Threads: 6H
- Material & Mechanical Properties: ISO 898-2, Fine Thread ISO 898-6